

BEFORE THE BOARD OF COUNTY COMMISSIONERS OF LANE COUNTY, OREGON

ORDER NO. 15-06-02-09

IN THE MATTER OF SETTING A PUBLIC HEARING  
FOR THE PROPOSED SURRENDER OF A PORTION  
OF MILLIRON ROAD (COUNTY ROAD NUMBER 339) TO  
THE CITY OF JUNCTION CITY (16-04-17 & 16-04-20)

**WHEREAS**, the City of Junction City, by its Resolution Number 1113, dated February 10, 2015, has requested that jurisdiction over the portion of Milliron Road be transferred from Lane County to the City of Junction City; and

**WHEREAS**, the portion of Milliron Road herein proposed for surrender extends from the easterly right of way of Highway 99 easterly approximately 0.14 mile to the northerly extension of the east line of a 40-foot wide public road easement dedicated as part of the State of Oregon Department of Corrections' facility access, commonly known as Dreas Way;

**WHEREAS**, the portion of road proposed for surrender lies within the city limits of Junction City, and was included within an annexation by Junction City in conjunction with development of the new correctional facility and hospital by the State of Oregon Department of Corrections; and

**WHEREAS**, the annexation was approved by Junction City Council Ordinance 1203 dated March 12, 2011, and was subsequently finalized as Annexation File C JC 2011-A-10-02; and

**WHEREAS**, this transfer comes as the final action of an Intergovernmental Agreement (IGA) between Lane County, the City of Junction City and the State of Oregon, by and through its Department of Corrections, authorized in 2012. This IGA in part facilitated improvements to Milliron Road to mitigate the impact of increased vehicular traffic resulting from the construction of the new correctional facility and hospital by the State of Oregon Department of Corrections. All road improvements were completed during the summer of 2013; and

**WHEREAS**, ORS 373.270 provides for the transfer from county jurisdiction to city jurisdiction of county roads within the corporate limits of a city whenever the county governing body deems it necessary, expedient or for the best interest of the county to do so, and the governing body of the city deems it necessary or expedient and for the best interest of the city to acquire jurisdiction over the county roads or parts thereof to the same extent as it has over other public streets and alleys of the city; and

**WHEREAS**, the Public Works Director of Lane County has recommended a public hearing date be established to consider the offer of surrender to Junction City of the portion of Milliron Road as described in Exhibit "A", and has provided a written report which is attached and made a part of this Order, and marked as Exhibit "B"; and

**WHEREAS**, the Board is of the opinion that setting a date to hold a public hearing is in the best interest of the public;

**NOW, THEREFORE,** the Board of Commissioners of Lane County **ORDERS** as follows:

1. That a public hearing be set for July 14, 2015 at 1:30 p.m., at the Lane County Courthouse, 125 East 8th Avenue, Eugene, Oregon, to formally consider the surrender of the portion of Milliron Road, County Road Number 339, as described in Exhibit "A", which is attached and made a part of this Order, to the City of Junction City;
2. That legal notice of hearing be posted or published, in accordance with ORS 373.270;
3. That the Director of the Lane County Department of Public Works prepare and provide a final report on the proposed surrender.

**ADOPTED** this: 2nd day of June, 2015.

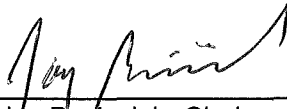

---

Jay Bozlevich, Chair  
LANE COUNTY BOARD OF COMMISSIONERS

APPROVED AS TO FORM

Date 5/24/15

---

LANE COUNTY OFFICE OF LEGAL COUNSEL

**EXHIBIT "A"**

**LEGAL DESCRIPTION**

**MILEAGE**

\*\*\*\*\*

MILLIRON ROAD (COUNTY ROAD NUMBER 339)

0.14

All that portion of Milliron Road (County Road Number 339) from the easterly right of way of U.S. Highway 99, thence easterly approximately 758 feet to the northerly extension of the easterly line of a 40.00 foot wide public road easement over the westerly 40.00 feet of the Plat of Booth Industrial Park, said plat recorded at Reception No. 2005-035436, Lane County, Oregon Plat Records and Lane County Surveyor's Office County Survey File No. 39286; said 40.00 foot wide public road easement was dedicated in those documents recorded at Reception Numbers 2011-001546 and 2011-001547, Lane County, Oregon Deed Records. The portion of Milliron Road described herein is all in Sections 17 and 20, Township 16 South, Range 4 West of the Willamette Meridian, Lane County, Oregon.

The above description for Milliron Road is shown on Exhibit "C" attached hereto and made a part hereof.

## EXHIBIT "B"

BEFORE THE BOARD OF COUNTY COMMISSIONERS OF LANE COUNTY, OREGON

DIRECTOR'S PRELIMINARY  
REPORT

IN THE MATTER OF SETTING A PUBLIC  
HEARING FOR THE PROPOSED SURRENDER  
OF A PORTION OF MILLIRON ROAD (COUNTY  
ROAD NUMBER 339) TO THE CITY OF JUNCTION  
CITY (16-04-17 & 16-04-20)

The City of Junction City has passed Resolution Number 1113, dated February 10, 2015, formally requesting the transfer of jurisdiction of a portion of Milliron Road (County Road Number 339) located within the city limits.

In 2011, in conjunction with development of a new correctional facility and hospital by the State of Oregon Department of Corrections by the State of Oregon Department of Corrections (D.O.C.), Junction City approved the annexation of the D.O.C. site by Ordinance No. 1203 dated March 12, 2011. Annexation File C JC 2011-A-10-02 by Junction City was subsequently finalized and included the subject portion of Milliron Road along with the D.O.C. site. The portion of Milliron Road herein proposed for surrender extends from the easterly right of way of Highway 99 easterly approximately 0.14 mile to the northerly extension of the east line of a public road easement dedicated as part of the D.O.C.'s facility access, commonly known as Dreas Way.

This transfer comes as the final action of an Intergovernmental Agreement (IGA) between Lane County, the City of Junction City and the State of Oregon, by and through its Department of Corrections, authorized in 2012. This IGA in part facilitated improvements to Milliron Road to mitigate the impact of increased vehicular traffic resulting from the construction of the new correctional facility and hospital by the State of Oregon Department of Corrections. All road improvements were completed during the summer of 2013.

Junction City has adopted Resolution Number 1113 formally requesting jurisdiction over the portion of the above mentioned county road, all within the city limits and described in Exhibit "A" of the attached Order, be transferred from Lane County to the City of Junction City.

ORS 373.270 provides for the transfer from county jurisdiction to city jurisdiction of county roads within the corporate limits of a city whenever the county governing body deems it necessary, expedient or for the best interest of the county to do so, and the governing body of the city deems it necessary or expedient and for the best interest of the city to acquire jurisdiction over the county roads or parts thereof to the same extent as it has over other public streets and alleys of the city.

Legal notice for the public hearing to consider the matter of the surrender of this portion of Milliron Road (County Road Number 339) is required by ORS 373.270. Setting this date for

the hearing will allow time for public posting or notice and is recommended as being appropriate.

The surrender of this portion of road will allow the City to have full jurisdiction of the road and to maintain, develop and improve it and the surrounding area to their own specifications, standards and timetables. It is therefore recommended that a public hearing date be established and that legal notice of the hearing be posted or published for the proposal to surrender to Junction City the portion of Milliron Road (County Road Number 339), as described in Exhibit "A."

**DATED** this 19<sup>th</sup> day of May, 2015.



\_\_\_\_\_  
Marsha A. Miller, Director  
Department of Public Works

# Portion of Milliron Road To be Surrendered to Junction City

Section 17 & 20, T. 16S. R. 4W. W.M.

Lane County



NO SCALE



City limits of Junction City

Vicinity Map

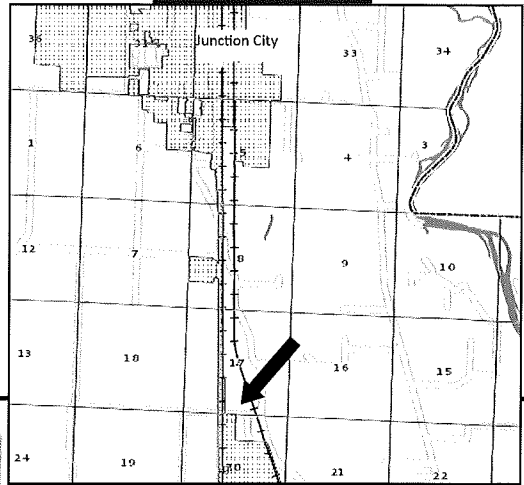

Portions of Right of Way  
to be Surrendered to  
Junction City

